

Gr 12 Floor Plans

Question 1

Study the plan below and answer the following questions;

Image

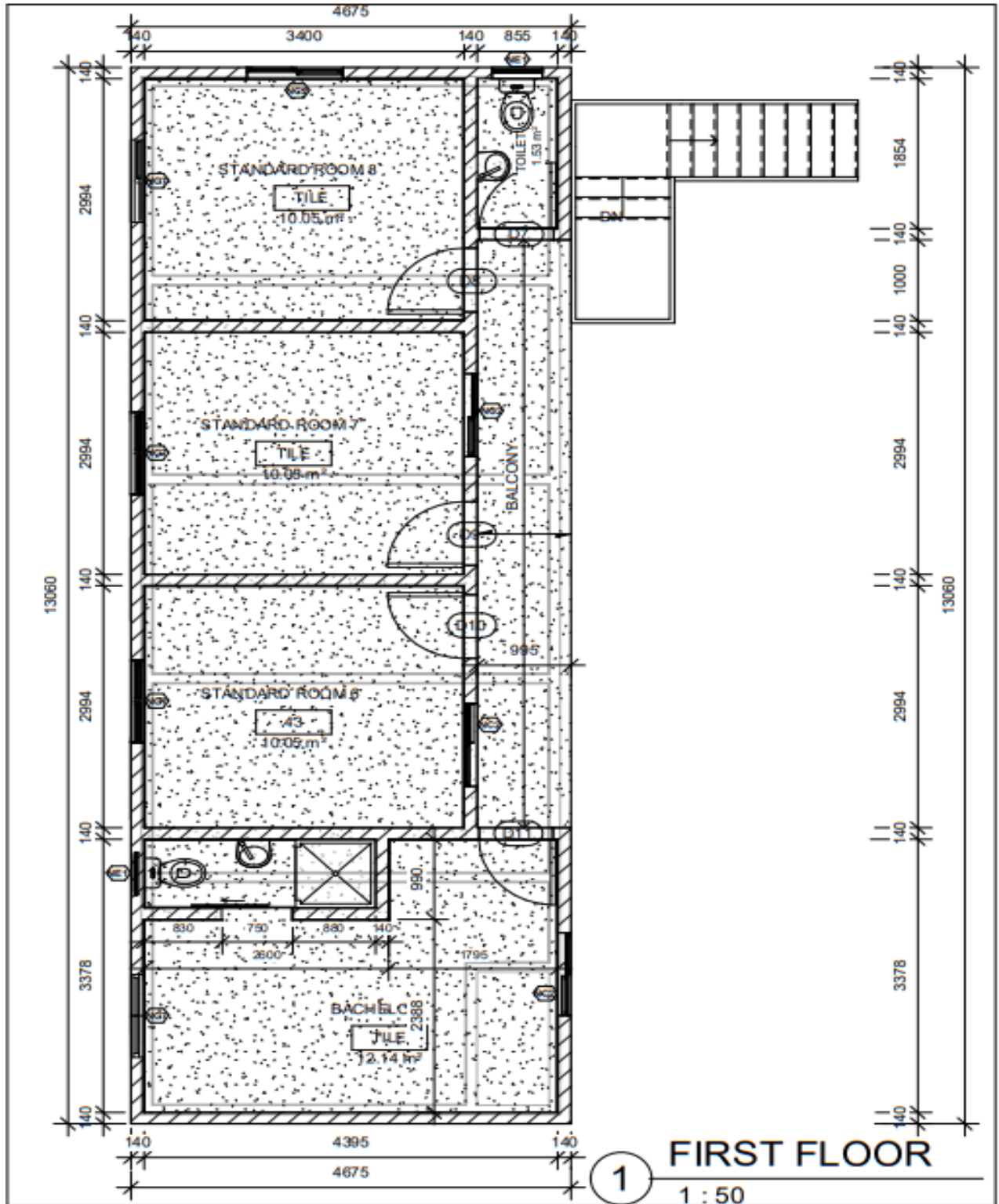

(a)

If you look at the plan, what is this building for?

Memo

One can see three rooms and a bachelor room. Tenants can rent these rooms from the owner.

(b)

What is the scale of the plan?

Memo

1 : 50

(c)

Explain in words the meaning of the scale.

Memo

One unit on the plan is 50 units in real life.

(d)

Calculate the area of a standard room.

Memo

Area is $l \times b$

$$Area = 3,4m \times 2,994m = 10,1796m^2$$

(e)

Is this a multy storey building?

Memo

Yes, because this is the first floor.

(f)

How many steps can you count to reach the first floor?

Memo

11 steps on the outside of the building.

(g)

How many toilets is on the first floor?

Memo

2

(f)

How thick are the walls?

Memo

140mm

(g)

What is the length of the building?

Memo

13,06 meter

(h)

The toilet is $1,53\text{m}^2$ on the plan.

Use your own calculations to see if this is correct.

Memo

$855\text{mm} \times 1854\text{mm} = 1\,585\,170\text{mm}^2$

$\approx 1,58\text{m}^2$ this is a mistake On the plan